

Luxy Star LED Desk Lamp

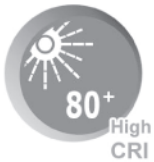

Luxy Lampe LL-01E

User's Manual



80+
High
CRI



Eco-friendly
LED



only
11W



Eye sight
Protection

Simple & Elegant

- *5 Step Brightness Dimming Control*
- *Anti-Glare Design / Eye protection*
- *30 Minute Timer*
- *Color Temperature: Cool white*
- *Available in 2 colors - Black or White*



Please read this instruction manual before operating or assembling this unit.

CAUTION

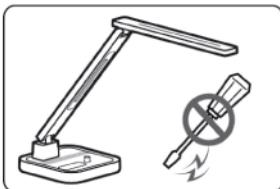

Do not repair, disassemble, or modify under any circumstances.

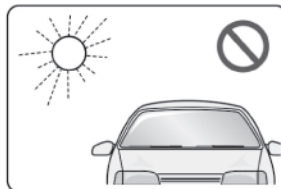

Do not place near any heat source or in direct sunlight.



Place on flat, secure surface.



Use **ONLY** the supplied AC power adaptor.

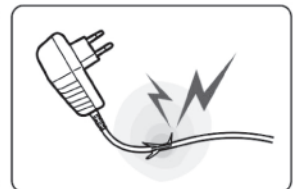

Do not use appliances with frayed or damaged electrical cord.



Do not touch electrical appliances with wet hands or when liquids are present.

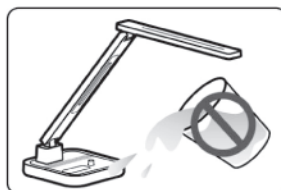

Please keep the light and all appliances dry and clean.

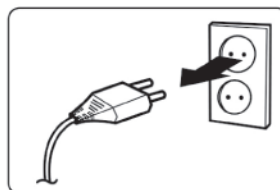

Unplug adaptor when the light will not be used for an extended period of time.



Clean only with a soft dry cloth and do not use solvents or cleaning solutions.

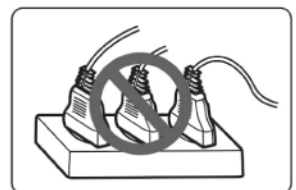

Never overload electrical circuits as it may cause electrical shock or fire.

Luxy Lampe LL-01E

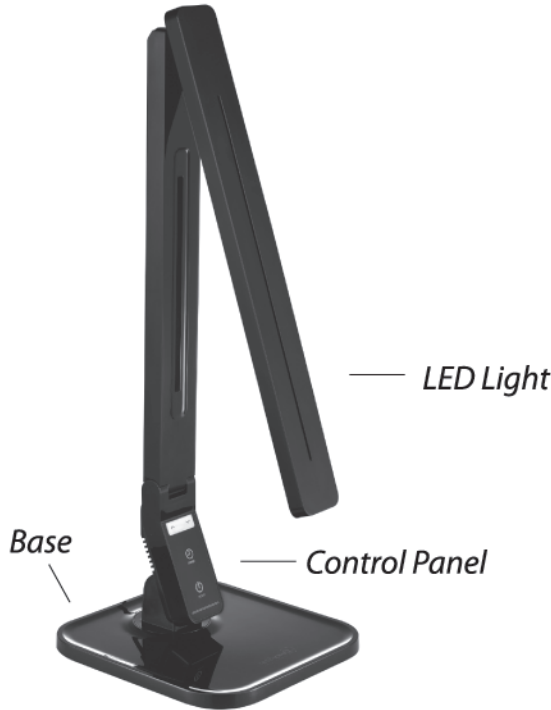

Brightness Control Function:

5 Step brightness touch control

Operating Modes:

Timer Control Function



Automatically turns-off the light in 30 minutes while in any mode of operation.

One Touch Control Function



Convenient to control functions of On/Off on various situations by simple touch method.

5 Steps Brightness Dimming Control



Assembly Instructions

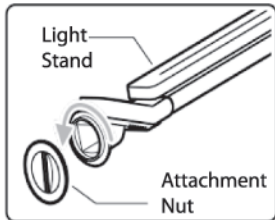

Step 1

Unscrew and remove the **Attachment Nut** from the **Light Stand**.

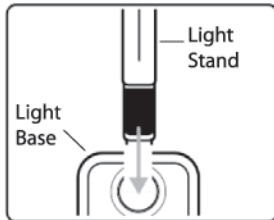

Step 2

Insert the **Light Stand** into round hole on the **Light Base** as shown.

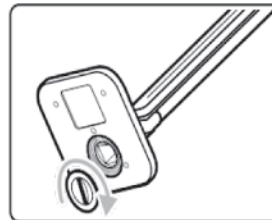

Step 3

Re-insert the **Attachment Nut** into the bottom of the **Light Stand** and tighten.

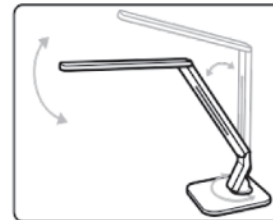

Step 4

Adjust the lamp to the desired position.

Adjustments

Parallel Arm

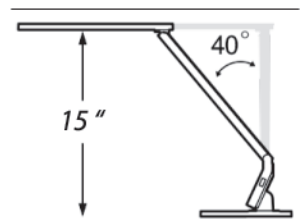

Light Head

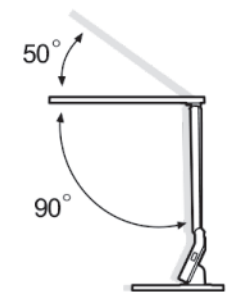

Lamp Base

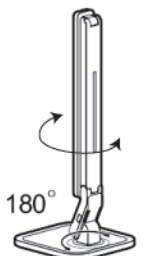

Operation Instructions



Dimming Control

The Dimming Control is operated by touch. Select up or down arrow and press down, to adjust light brightness.



Timer

The 30 Minute Timer is operated by touch. Select mode and press down.



On/Off

The On/Off button is operated by touch. Select mode and press down.