

Luxy Star LED Desk Lamp



Luxy Lampe LL-01 User's Manual



80+
High
CRI



Eco-friendly
LED



only
11W



Eye sight
Protection

Smart Mode Control LED Panel

- 5 Step Brightness Dimming Control
- Anti-Glare Design / Eye Protection
- 4 Mode Smart Control LED Panel
- USB Port for all Smart Phone Charging

Please read this instruction manual before operating or assembling this unit.

CAUTION

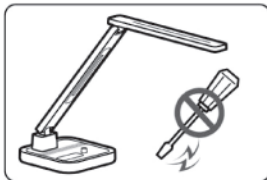

Do not repair, disassemble, or modify under any circumstances.

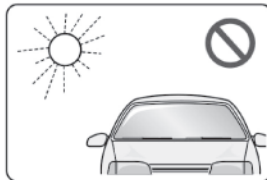

Do not place near any heat source or in direct sunlight.



Place on flat, secure surface.



Use **ONLY** the supplied AC power adaptor.

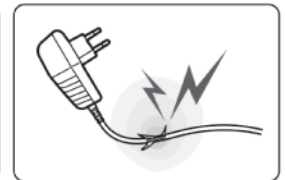

Do not use appliances with frayed or damaged electrical cord.



Do not touch electrical appliances with wet hands or when liquids are present.



Please keep the light and all appliances dry and clean.

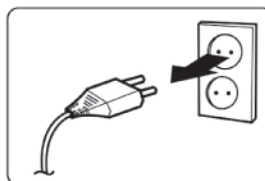

Unplug adaptor when the light will not be used for an extended period of time.



Clean only with a soft dry cloth and do not use solvents or cleaning solutions.

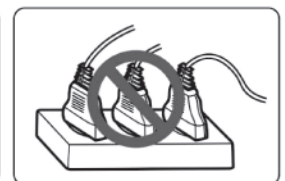

Never overload electrical circuits as it may cause electrical shock or fire.

Luxy Lampe LL-01

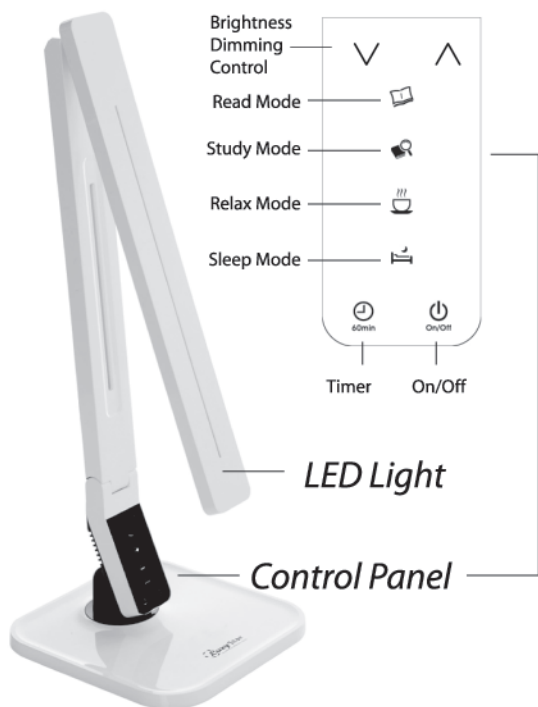

Brightness Control Function:

5 Step Brightness Dimming Control

Operating Modes:

Read Mode (4,500K ~ 5,500K)

It stimulates concentration and reduces eye strain with the choice of mid-range color temperature.

Study Mode (5,500K ~ 6,700K)

Increases attention and concentration with the choice of high-range color temperature.

Relax Mode (2,700K ~ 3,700K)

Promotes relaxation along with improved mood and the choice of low-range color temperature.

Sleep Mode (2,700K ~ 3,300K)

Encourage a deep sleep with the comfort of soft light.

Timer Control Function

Automatically turns-off the light in one (1) hour while in any mode of operation.

One Touch Control Function

Convenient to control functions of On/Off on various situations by simple touch method.

USB Power Charging Port:

Possible to recharge various digital devices such as MP3 and Mobile Phones through the USB Power Charging port supplying 5V (700mA) power. (USB Power Charging adaptors are sold separately)

Assembly Instructions

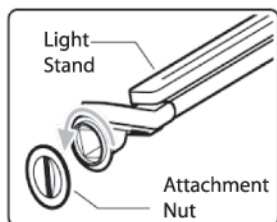

Step 1

Unscrew and remove the **Attachment Nut** from the **Light Stand**.

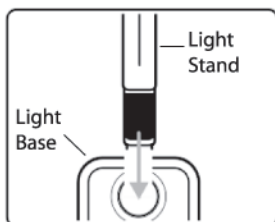

Step 2

Insert the **Light Stand** into round hole on the **Light Base** as shown

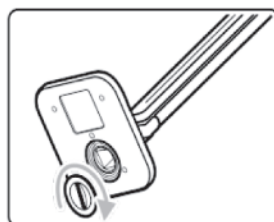

Step 3

Re-insert the **Attachment Nut** into the bottom of the **Light Stand** and tighten.

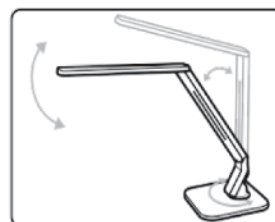

Step 4

Adjust the lamp to the desired position.

Adjustments

Parallel Arm

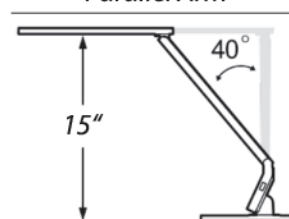

Light Head

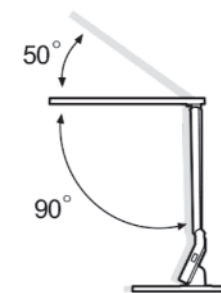

Lamp Base

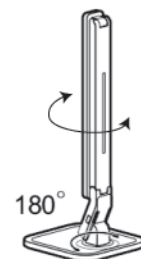

Operation Instructions



Control Panel

Select the desired Lighting Mode and press down.



USB Power Charging Port

Step 1a

To use the USB Charging Port, insert the USB cable into the USB Power Charging Port and connect the smart device to the USB cable.

To ensuring proper docking look for the charging icon on your smart device.



Step 1b

Charging icon may vary depending on device.